

ordering
 e of the spare
 is made up
 adding 10
 ore spare part
 ber.
 . 024
 24

ing code
part is
adding spare
r.

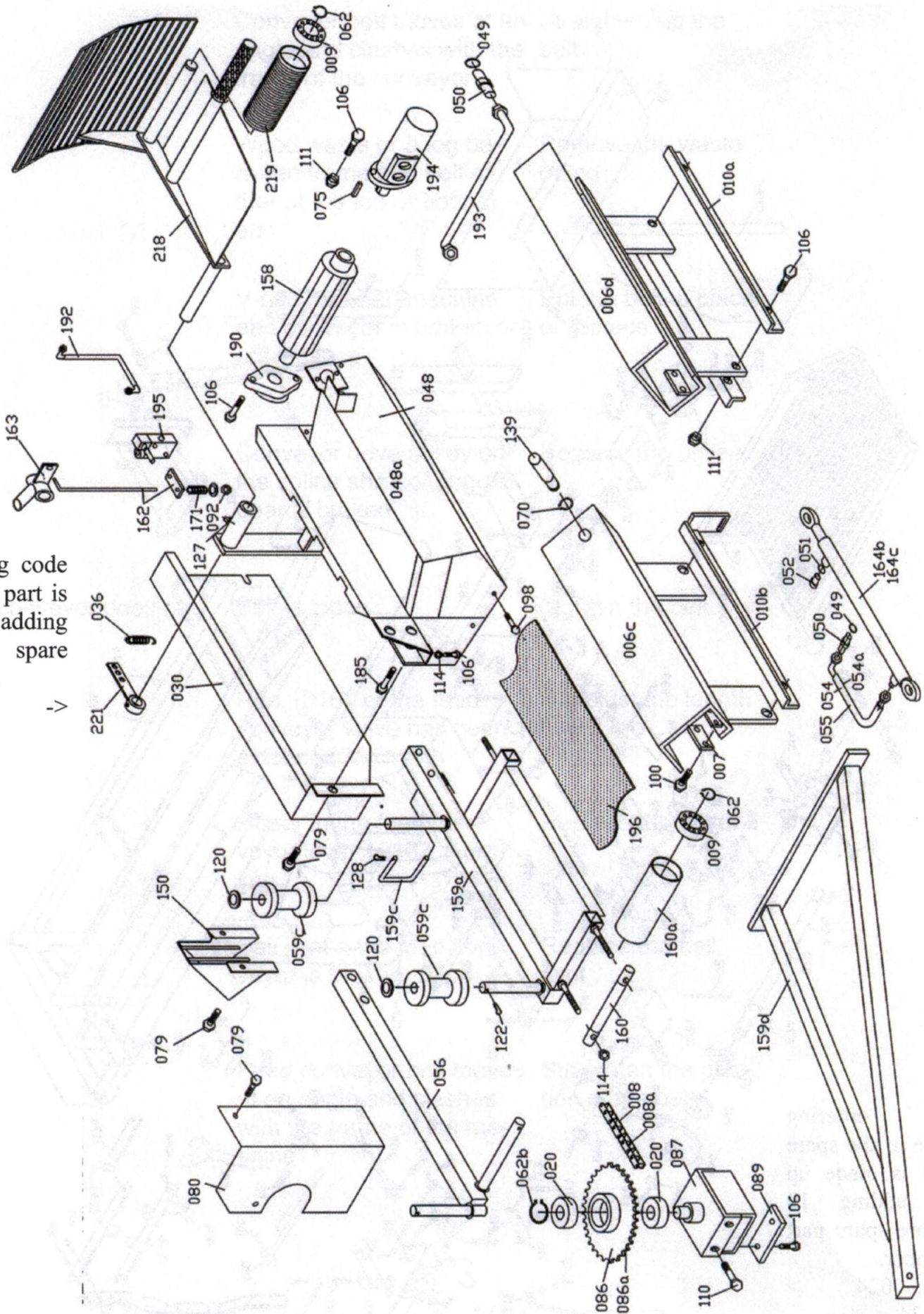

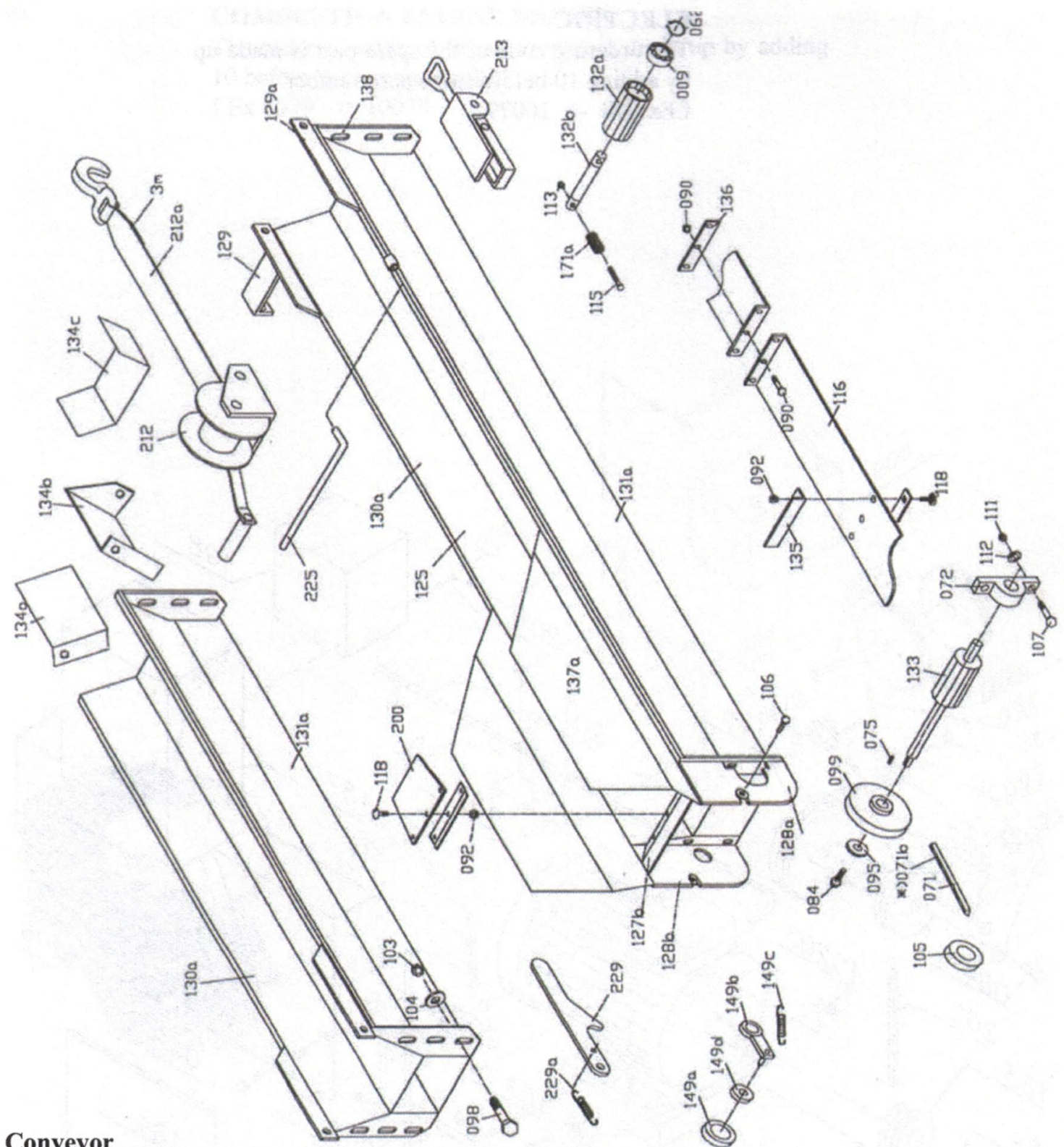

Conveyor

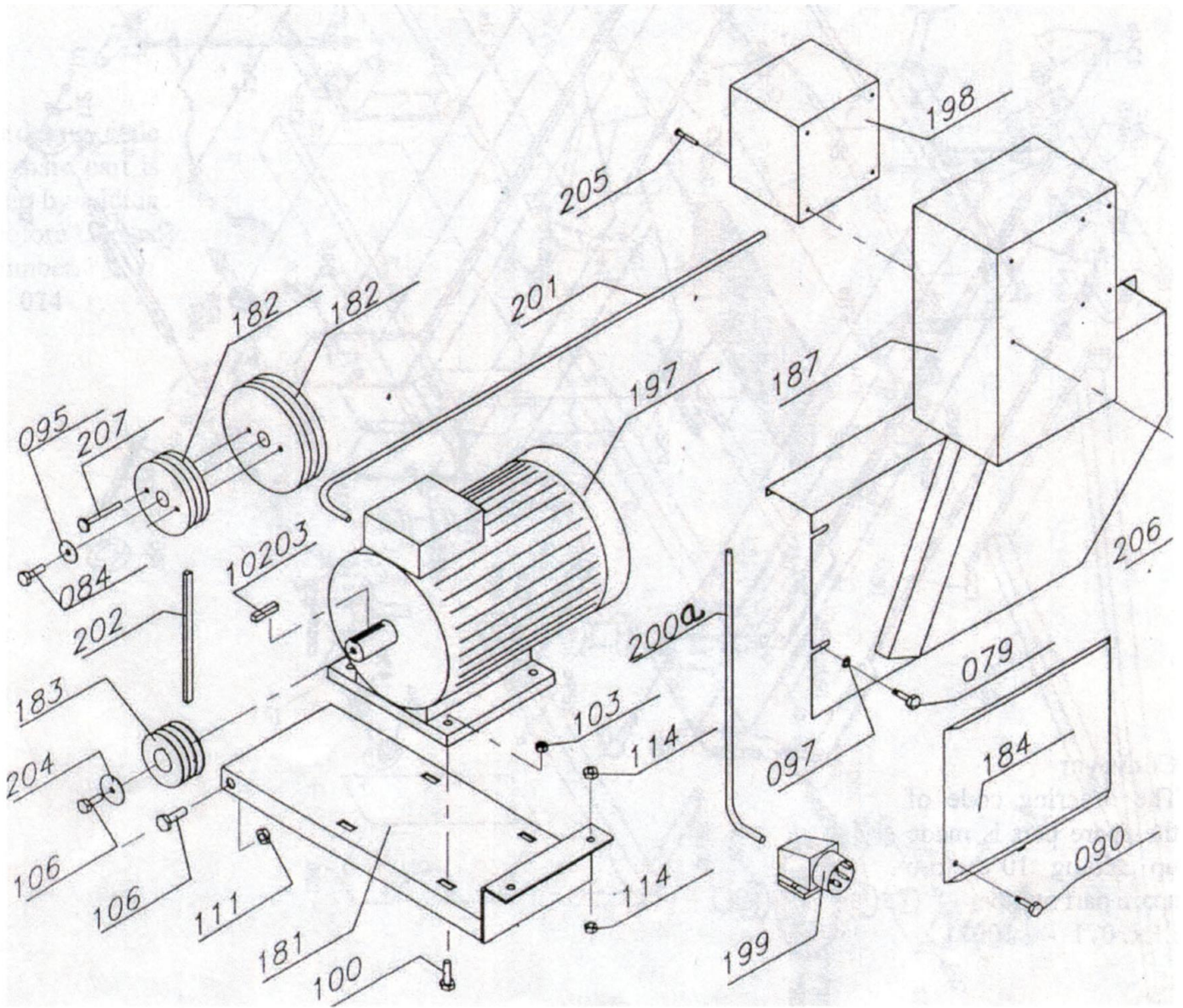

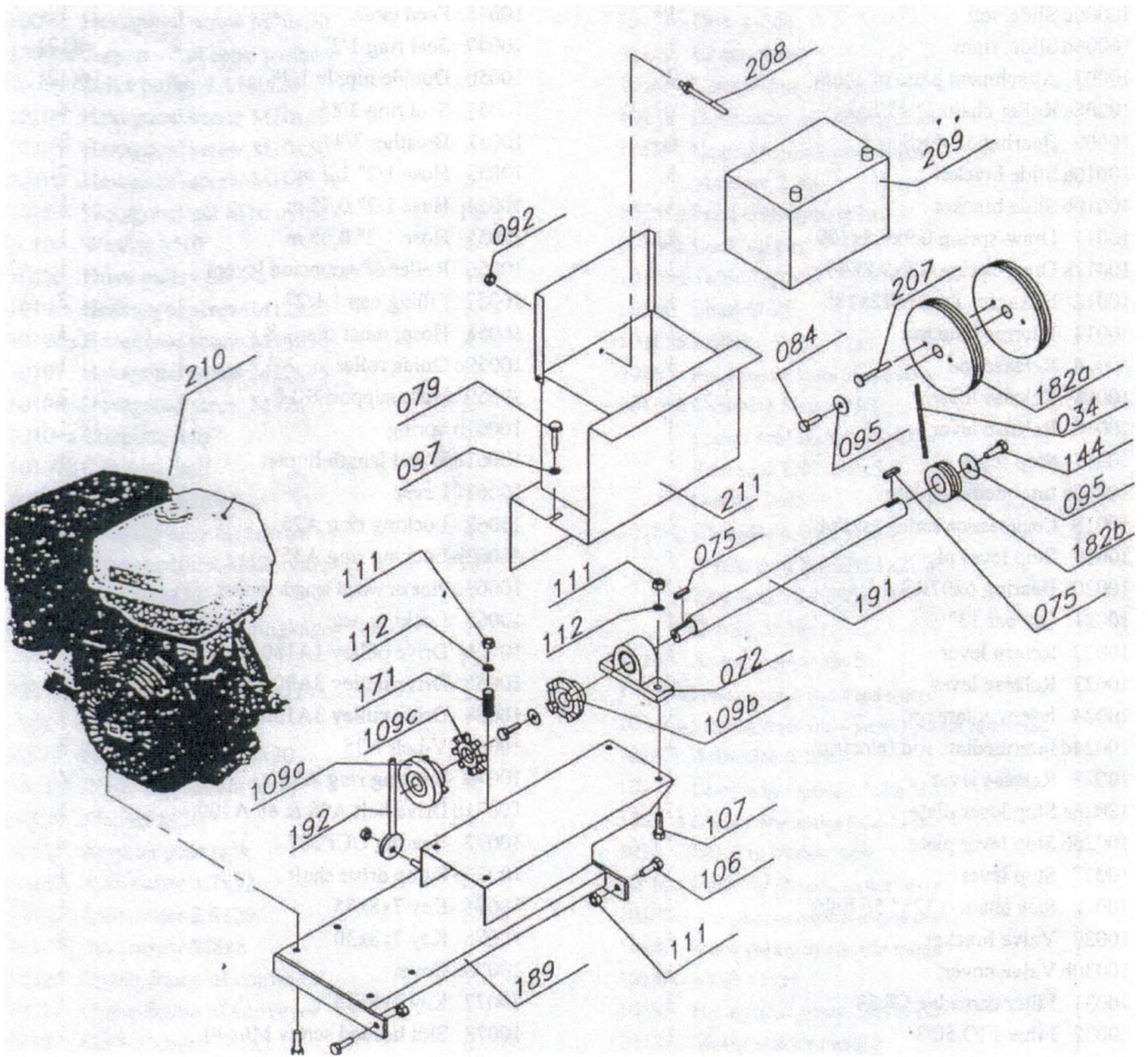

Spare part list

Hakki Pilke 2X P			
Item	Pc		
10001b Frame	1	10041 Sawbar attachment plate	1
10002a Angular gear B2021	1	10042 Cock	1
10003 Valve	1	10043 Hose tightener 35	2
10003a Ball joint of valve	1	10044 Sawbar attachment plate	1
10004b Upper cover	1	10045 Suction hose, inner diam. 25	1
10005 Hydraulic pump 16	1	10046 Sawbar attachment pin	1
10006c Slide, left	1	10047 Angular fitting 90 3/4"	1
10006d Slide, right	1	10048b Feed conveyor table	1
10007 Attachment plate of chain	2	10048c Feed table	1
10008a Roller chain 1" 47 links		10049 Seal ring 1/2"	6(12)
10009 Bearing 6205RS	4	10050 Double nipple 1/2"	6(12)
10010a Slide bracket	3	10051 Seal ring 3/8"	4
10010b Slide bracket	1	10052 Breather 3/8"	2
10011 Draw-spring 0.9x9.8x100	1	10053 Hose 1/2" 1,7 m	2
10011a Draw-spring 0.9x9.8x40	1	10054 Hose 1/2" 0,75 m	1
10012 Hexagonal nut M12x180	1	10055 Hose 1/2" 0,65 m	1
10013 Intermediate rod	1	10056 Roller of extension lever	1
10014 Release rod	1	10057 Filling cap 1 1/2"	2
10015 Release lifter	1	10058 Hose, inner diam. 8	1
10016 Release lever	1	10059c Guide roller	1
10017 Stop lever	1	10060 Hose support 8-14	2
10017a Intermediate plate	1	10061b Spring	1
10018 Compression spring 2x22x40	1	10061e Wood length limiter	1
10019 Stop lever plate	1	10061f Lever	1
10020 Bearing 6207RS	2	10062 Locking ring A25	2(7)
10021 Sawbar 13"	1	10062b Locking ring A35	2
10022 Return lever	1	10063a Pipe of wood length limiter	1
10023 Release lever	2	10065 Locking peg	1
10024 Intermediate rod	1	10066 Drive pulley 1A180/35	1
10024d Intermediate rod (electric)	1	10067 Drive pulley 3A90/35	1
10025 Release lever	1	10068 Drive pulley 3A180/25	1
10026a Stop lever plate	1	10069 V-belt A38	3
10026b Stop lever plate	1	10070 Locking ring A30	4
10027 Stop lever	1	10071b Drive belt A98 & el. A100	1
10028 Saw chain 0,325" 56 links	1	10072 Bearing UCP207	4
10029 Valve bracket	1	10073a Pump drive shaft	1
10030b Valve cover	1	10074 Key 7x8x75	1
10031 Filter cartridge CR50	1	10075 Key 7x8x30	3
10032 Filter FIO 50/3	1	10076a Cover	1
10034 Drive belt XPA882	1	10077 Key 7x8x15	1
10035 Spring tensioner	1	10078 Slot headed screw M6x40	1
10036 Draw-spring 3.5x30x190	1	10079 Hexagonal screw M8x12	12
10037 Sawbar bracket	1	10097a Cover	1
10038 Hose, inner diam. 8	1	10080 Cover	1
10039 Drive pulley 1A80	1	10081 Pump bracket	1
10040 Drive shaft of saw chain	1	10082 Draw pin	2
		10083 Chain drive plate	1
		10084 Hexagonal screw M8x20 16 10.9	2

10085	Drive shaft of saw	1	10134b	Sideplate, right	1
10086a	Sprocket 1" Z21	1	10134c	Top end cover	1
10087	Shaft casing	1	10135	Scraper of conveyor	9
10088	Hexagonal screw M8x55 10.9	3	10136	Jointing plate of belt	2
10089	Fastening plate of tension wheel	1	10139	Cylinder pin	2
10090	Allen screw M8x35	10	10143	Control lever	1
10091	Hexagonal screw M8x60	4	10144	Hexagonal screw M10x20	2
10092	Hexagonal nut M8	48	10145	Valve lever	1
10093	Hexagonal screw M6x20	2	10149a	Tension wheel	1
10094	Washer M8	20	10149b	Bar of tension wheel	1
10095	Washer M10/36	4	10149c	Drive spring 2x20x100	1
10096	Washer M8/27	1	10149d	Bearing 6203 2RS	1
10098	Hexagonal screw M10x30	6	10150	Dust guide	1
10098c	Support rod of upper position	1	10152	Chain cover	1
10099	Drive pulley 1A180/28	1	10155	Control bar of valve	1
10100	Hexagonal screw M10x40	4	10158	Drive roller of feed conveyor	1
10101	Hexagonal screw M10x50	4	10159	Extension roller pipe of feed conveyor 2.2m	1
10102	Hexagonal screw M10x130	4	10159a	Feed conveyor 2.2m	1
10103	Hexagonal nut M10 nyloc	16	10159c	Locking peg	1
10104	Washer M10	4	10159d	Table support	1
10105	Drive pulley 80/6-u	1	10160	Shaft Ø 25	1
10106	Hexagonal screw M12x35	8	10160a	Roller	1
10106a	Hexagonal screw M14x35	4	10163	Blade control lever (feed conv.)	1
10107	Hexagonal screw M12x45	8	10164b	Cylinder 50/32-710 piston seal SM50/38x20w Rod seal TS32/40x5.8 O-ring 3x45	2
10108	Hexagonal screw M12x70	2	10164c	Cylinder 64/45-710 Piston seal SM63/51x20w Rod seal TS45/55x10 O-ring 3x58	2
10109a	Coupling half	1	10165	Angular gear shaft	1
10109b	Coupling half	1	10166a	Splitting blade into 2 and 4 parts	1
10109c	Coupling rubber	1	10166c	Splitting blade into 6 parts (optional equip,emt)	1
10110	Hexagonal screw M12x80 full thr.	4	10167	Articulated lever	1
10111	Hexagonal nut M12 nyloc	17	10171	Compression spring 2.5x20x38	3
10112	Washer M12	4	10171a	Compression spring 3.5x22x38	4
10113	Blade adjustment linkage	1	10181	Electric motor rack	1
10114	Hexagonal nut M12	10	10182	Idlers for electric motor drive	1
10115	Hexagonal screw M12x120	2	10182a	Idlers for combustion engine drive	1
10116	Belt 240x8200	1	10183	Drive pulley of electric motor	1
10118	Locking screw M8x20	30	10184	Shaft cover	1
10119	Blade adjustment lever	1	10185	Hexagonal screw M12x60	1
10120	Washer M20	4	10187	Motor starter casing	1
10121	Angular gear rack	1	10189	Combustion engine rack	1
10122	Split cotter 3.2x32	4	10190	Bearing UCFL205	1
10123	Split cotter 2.5x20	3	10191	Combustion engine shaft	1
10124	Stop screw M8x8	8	10192	Hose 1/2" 0,75 m	1
10125	Lower frame of conveyor	1	10193	Hose 1/2" 0,8 m	2
10126	Upper frame of conveyor	1	10194	Hydraulic motor OMP400	1
10127	Grease nipple M8x1	6			
10128	Cotter M3	2			
10130	Intermediate block 1m				
10132a	Upper roller 100x240	1			
10132b	Upper roller shaft	1			
10133	Drive roller Ø 100	1			
10134a	Side plate, left	1			

10195	Valve SD4/1 neg. kj.	1
10196	Belt 200x4600 (2.2m)	1
10197	Electric motor 7,5kW/1500	1
10198	Motor starter 7.5kW	1
10199	Connector 5x32A	1
10200	Rubber flap	1
10200a	Rubber cable 5x2.5x2.5m	1
10201	Rubber cable 7x1.5x2m	1
10203	V-belt A36	3
10204	Washer	1
10205	Slot ended screw M4x20	4
10206	Hexagonal nut M4	4
10207	Hexagonal screw	2
10208	Battery rack	1
10209	Battery	1
10210	Combustion engine 13 hp	1
10211	Cover	1
10212	Winch	1
10212a	Winch line 3m with hook	1
10213	Bolt	1
10218	Cover	1
10219	Roller	1
10221	Spring bracket	1
10225	Belt holder	1
10229	Locking peg of conveyor	1
10229a	Spring 2x15x150	1
10230	Fastening parts of winch	1
10231	Lubrication valve	1
10320	Locking bar of blade	1
10321	Fastening of locking bar	1